



WILLOWGREEN

ESTATE AGENTS

**37 Old Maltongate, Malton  
Yorkshire YO17 7EH**



**Guide price £245,000**

# 37 Old Maltongate, Malton, Yorkshire YO17 7EH

Viewing highly recommended for 37 Old Maltongate, a charming Grade II listed two bedroom double fronted Georgian cottage located within the heart of Malton. This property has been lovingly restored over recent years by the current owners and retains many original features.

The property in brief comprises; entrance hall with stairs to first floor, sitting room with spacious understairs storage cupboard and open plan kitchen diner with stable door to rear garden. To the first floor there are two double bedrooms and house bathroom.

Outside there is a rear courtyard with outbuilding currently housing washing machine. A range of mature plants, shrubs and rear access.

Car parking solutions available.

EPC Exempt.

## ENTRANCE HALL

Hardwood front door with glass panel windows above, stairs leading to first floor, ceiling rose, power points, radiator.

## KITCHEN/DINER

17'7" x 11'5" (5.36m x 3.48m)

Wooden stable door, wooden window to rear aspect, window to front aspect, radiator, wall and base units with sink, combi-boiler and space for electric cooker.



## SITTING ROOM

11'11" x 10'4" (3.63m x 3.15m)

Wooden sash window to front aspect, ceiling rose, picture rail, storage cupboards and shelving, radiator, power points, wall lights and large under stairs cupboard.



## FIRST FLOOR LANDING

Wooden window to rear aspect, original wood flooring, dado rail, ceiling rose, loft access.



## BEDROOM ONE

15'8" x 8'7" (4.80 x 2.64)

Wooden window to front aspect, original wood flooring, ceiling rose. feature fireplace, radiator, power points.



## BEDROOM TWO

11'10" x 10'4" (3.63 x 3.15)

Wooden window to front aspect, original wood flooring, ceiling rose, feature fireplace, power points, radiator.



## BATHROOM

4'11" x 5'06" (1.50m x 1.68m)

Window to rear aspect, original wood flooring, free standing bath, wash hand basin with pedestal, radiator & low flush WC.



**OUTSIDE STORE/UTILITY**

6'3" x 6'2" (1.91 x 1.88)

Window to side aspect. Leads through to another store room.

**SERVICES**

Mains gas, water, electric and drainage.

**GARDEN**

Outside there is a rear courtyard with outbuilding currently housing washing machine. raised vegetables beds, range of plant, shrubs and rear access.

**PARKING**

On-street parking. You may be able to enquire with a few local places to get parking permit.

**COUNCIL TAX BAND B**





# Old Maltongate, Malton, YO17

Approximate Area = 882 sq ft / 81.9 sq m

For identification only - Not to scale



FIRST FLOOR

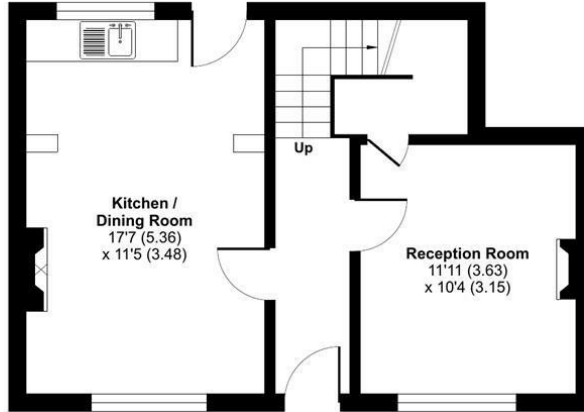

GROUND FLOOR



Floor plan produced in accordance with RICS Property Measurement Standards incorporating International Property Measurement Standards (IPMS2 Residential). © richrecom 2023. Produced for Willowgreen Estate Agents. REF: 939100



01653 916 600 | enquiries@willowgreenestateagents.co.uk

6-8 Market St, Malton, North Yorkshire YO17 7LY

Registered Office: 6-8 Market St, Malton, North Yorkshire YO17 7LY | Reg No. 06364398